

JURD PARK, COLO VALE

LANDSCAPE ARCHITECTURAL CONCEPT PACKAGE

Issue: A

Date: 25.06.2024

DRAWING SCHEDULE

DRAWING NO.	TITLE	SCALE
SK-2243-01	Opportunities & Constraints	N/A
SK-2243-02	Design Images	N/A
SK-2243-03	Concept Masterplan	1:500 @ A1

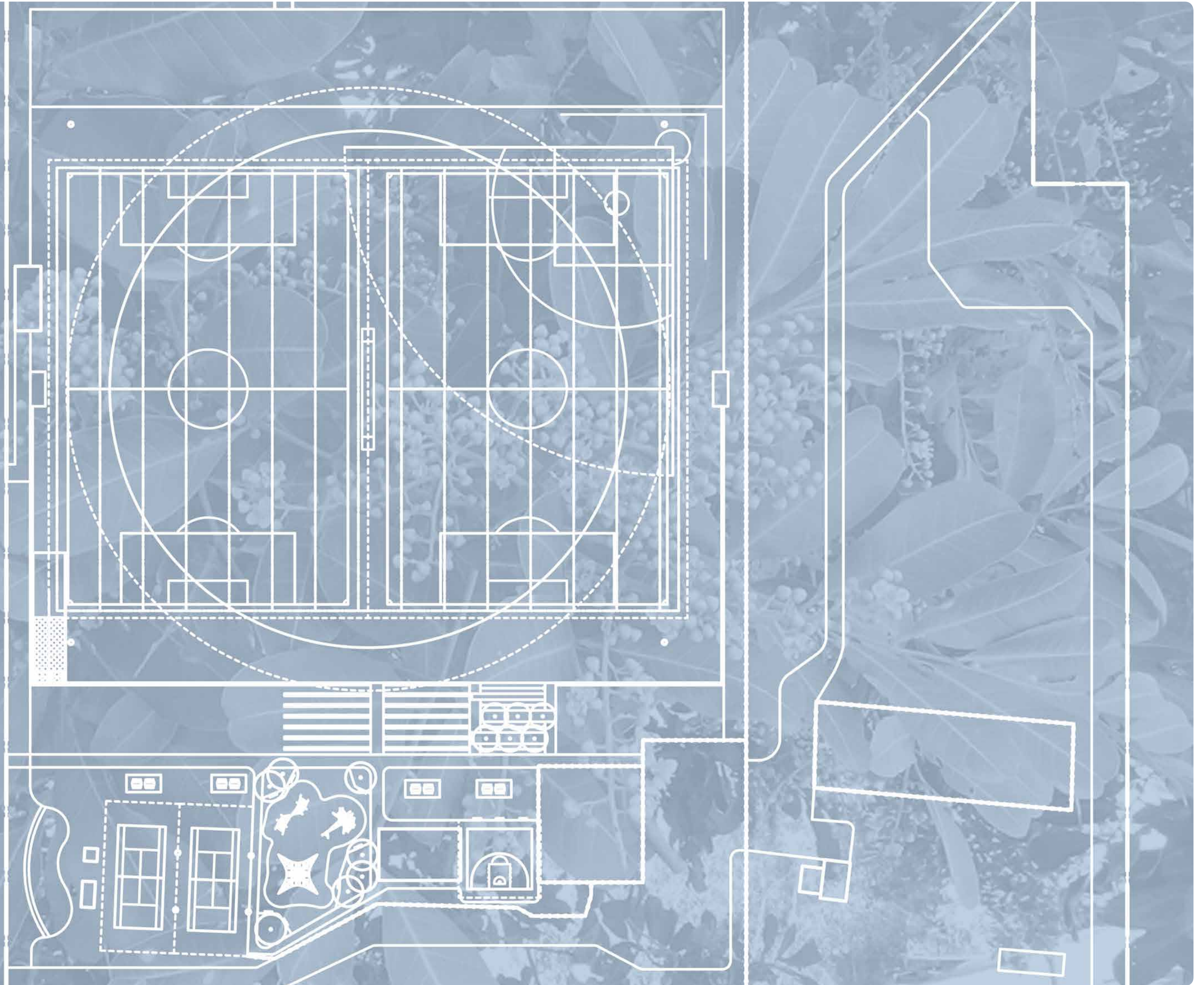

SITE PLAN - OPPORTUNITIES & CONSTRAINTS



SITE IMAGES



1 Septic Tank & Existing fencing



2 Existing amenities building and fence

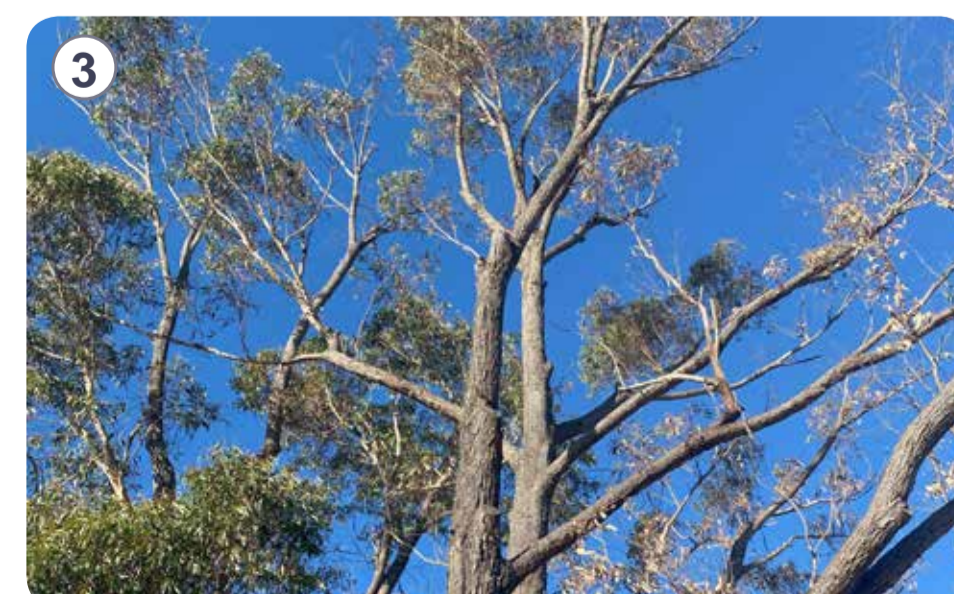

3 Noted trees under stress



4 Existing trench drain/swale



5 Eroded driveway entry to pony club

Sturt Noble
Associates

Suite 307, 166 Glebe Point Road
Glebe NSW 2007
T. 02 9211 3744
W. www.sturtnoble.com.au
landscape architecture
environmental & urban design

PROJECT
JURD PARK, COLO VALE

CLIENT
WINGECARRIBEE SHIRE COUNCIL

DRAWING
SITE PLAN - OPPORTUNITIES & CONSTRAINTS

DRAWING No.	ISSUE	DRAWN	DATE
SK-2411-JP-01	A	ml	25.06.2024



ACN: 164 245 514 ABN: 99 164 245 514
THIS DRAWING SHOULD BE READ IN CONJUNCTION WITH ALL RELEVANT CONTRACTS, SPECIFICATIONS, REPORTS AND DRAWINGS. COPYRIGHT OF THIS DRAWING IS VESTED IN STURT NOBLE ASSOCIATES PTY LTD.



Half-court basketball with linemarking



Soccer field



Tennis court lighting



Level 2 playground upgrade



Tiered seating space with turf inbetween



Sporting & Maintenance shed



Picnic shelter with table setting for shaded gathering areas



Cricket nets



Sporting field flood lights

Suite 307, 166 Glebe Point Road
Glebe NSW 2007
T. 02 9211 3744
W. www.sturtnoble.com.au
landscape architecture
environmental & urban design

PROJECT
JURD PARK, COLO VALE

CLIENT
WINGECARRIBEE SHIRE COUNCIL

DRAWING
DESIGN IMAGES

DRAWING No.	ISSUE	DRAWN	DATE
SK-2411-JP-02	A	ml	25.06.2024



ACN: 164 245 514 ABN: 99 164 245 514
THIS DRAWING SHOULD BE READ IN CONJUNCTION WITH ALL RELEVANT
CONTRACTS, SPECIFICATIONS, REPORTS AND DRAWINGS. COPYRIGHT
OF THIS DRAWINGS IS VESTED IN STURT NOBLE ASSOCIATES PTY LTD.

SITE PLAN - CONCEPT MASTERPLAN

LEGEND

- Site boundary
- - - Subsoil drainage system to allow for wet weather use & limit inundation of sporting fields following rain events
- ① Protect existing ecological area with revegetation to bushland areas
- ② Half court basketball court
- ③ Upgraded Level 2 playground area with net climbing structures
- ④ DDA accessible path to field with feature planting
- ⑤ Tiered seating space with sandstone blocks & turf
- ⑥ 2 x Cricket Nets
- ⑦ Maintenance/storage shed for turf maintenance and sports clubs
- ⑧ 3m wide gravel driveway access to shed and fields
- ⑨ Gravel access driveway to pony shed with slope/turf stabilisation
- ⑩ Horse washing station with hardstand and drainage
- ⑪ Concrete circulation path
- ⑫ Football dugout to future details
- ⑬ Sports flood lights to allow night use of facilities.
- ⑭ Open turf and picnic tables for gathering
- ⑮ Native garden & access path providing amenity to tennis courts

KEY IMAGES



Suite 307, 166 Glebe Point Road
 Glebe NSW 2007
 T. 02 9211 3744
 W. www.sturnoble.com.au
 landscape architecture
 environmental & urban design

PROJECT
JURD PARK, COLO VALE

CLIENT
WINGECARRIBEE SHIRE COUNCIL

DRAWING
SITE PLAN - CONCEPT MASTERPLAN

DRAWING No.	ISSUE	DRAWN	DATE
SK-2411-JP-03	A	ml	25.06.2024

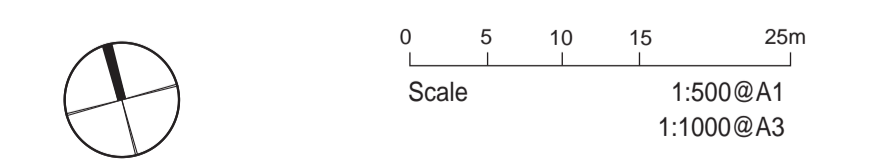

ACN: 164 245 514 ABN: 99 164 245 514
 THIS DRAWING SHOULD BE READ IN CONJUNCTION WITH ALL RELEVANT CONTRACTS, SPECIFICATIONS, REPORTS AND DRAWINGS. COPYRIGHT OF THIS DRAWINGS IS VESTED IN STURT NOBLE ASSOCIATES PTY LTD.

